

*Rex* Gooding



**The Granary, Morris Farm, Aslockton Road,**

**Guide Price: £699,950**



# The Granary, Morris Farm, Aslockton Road, Scarrington, NG13 9BP

The Granary enjoys a lovely, private plot of over 1/3 of an acre consisting of a 3 bedroom barn conversion, attached large brick built barn that would suit conversion to residential (subject to planning). A further open fronted brick outbuilding and a large open sided barn/store. Detached brick built garage with garden room to the rear. This interesting property offers a barn conversion that is ready to move into with some interesting outbuildings with huge development potential or even the creation of secondary accommodation (subject to planning). Located in the beautiful Vale of Belvoir village of Scarrington only a 5 mins drive from the market town of Bingham. No upward chain.

## Accommodation & Amenities

- Two/Three Bedroom Barn Conversion
- Large Brick Built Barn Ripe for Conversion
- Former Stable Block
- Large Open Sided Barn/Store
- Detached Brick Built Garage Block with Garden Room
- Over 1/3 of an Acre Private Plot
- Highly Regarded Vale of Belvoir Village
- Rare Opportunity in this Location
- No Upward Chain
- N.B The Open Sided Large Barn has an Asbestos Roof

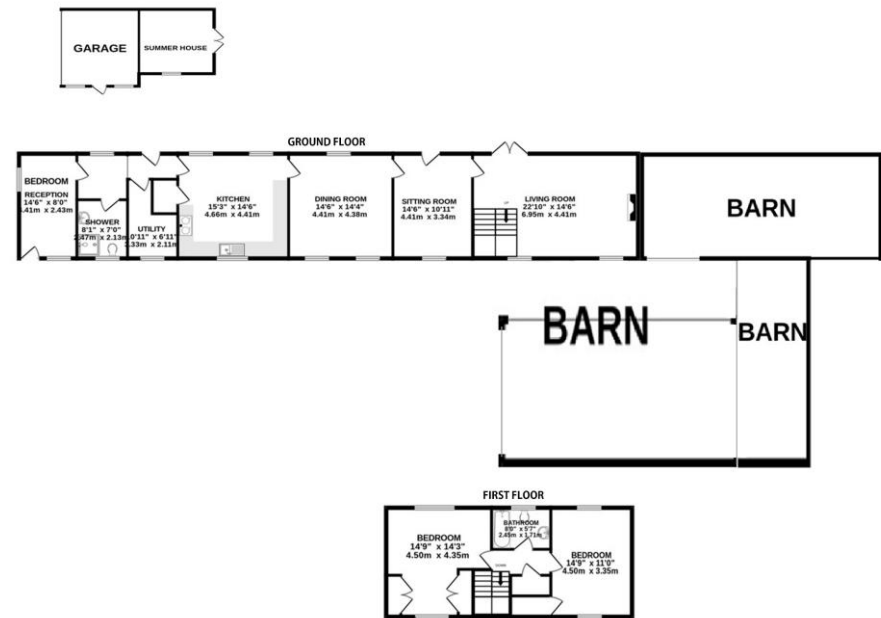

TOTAL FLOOR AREA : 3003 sq.ft. (279.0 sq.m.) approx.  
While every attempt has been made to ensure the accuracy of the floorplan contained here, measurements of doors, windows, rooms and any other items are approximate and no responsibility is taken for any error, omission or mis-statement. This plan is for illustrative purposes only and should be used as such for any prospective purchase. The services, systems and appliances shown have not been tested and no guarantee as to their operability or efficiency can be given.  
Made with Metropix C2023































